

wall mounting socket outlet - housing dimensions 90x90



Product description	
BALS-Prd.-Nr	11190-BE
EAN	4024941945684
Product category	Wall mounting socket outlet
Current	32A
Number of poles	5p
Arrangement of phases	3p+N+PE
Position of earth contact	6 h
Voltage	200/346 - 240/415V~
Frequency	50/60Hz

Product description	
Protection degree	IP44
Colour code	red RAL 3000
Colour of appliance	Hinged lid grey RAL 7035, Enclosure grey RAL 7035, Housing bottom grey RAL 7035
Connection design	with screw terminal
Maximum conductor size	10,0 qmm
Cable entry	other
Height	112.5mm
Width	90mm
Depth	93mm
Dimension of enclosure	90x90 mm
Material of enclosure	Polyamide
Contacts	The contact carrier is made of polyamide, the contacts are brass nickel plated

Additional technical information	
	The cable entry is one at top open and one at bottom closed
	straight

Logistics data	
Weight/pcs	0.4 kg / Piece
Packaging	Bag
Content amount	1 ST

Logistics data	
EAN	4024941945684
Length	93 mm
Width	90 mm
Height	112.5 mm
Weight	0.401 kg
Volume	941.625 ccm
Packaging	Carton
Content amount	5 ST
EAN	4024941945691
Length	295 mm
Width	185 mm
Height	215 mm
Weight	2.164 kg
Volume	9,975 ccm

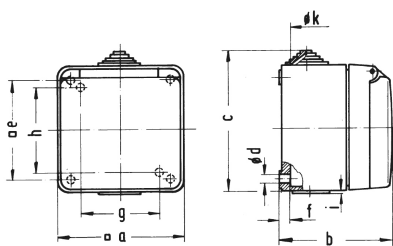

Ampere Polzahl	16 3	16 5	32 5				
a □	91,0	91,0	90,0				
b	79,5	79,5	93,0				
c	100,0	100,0	112,5				
d ø	5,5	5,5	5,5				
e □	73,0	73,0	-				
f	7,0	7,0	6,0				
g	-	-	58,0				
h ø	-	-	73,0				
i	-	-	1,5				
k ø	20,0 max.	20,0 max.	8,0/ 20,0				

4 MB 16