

## Wall mounting socket outlet - housing dimensions 90x90



| Product description       |                             |
|---------------------------|-----------------------------|
| BALS-Prd.-Nr              | 11190-BE                    |
| EAN                       | 4024941945684               |
| Product category          | Wall mounting socket outlet |
| Current                   | 32A                         |
| Number of poles           | 5p                          |
| Arrangement of phases     | 3p+N+PE                     |
| Position of earth contact | 6 h                         |
| Voltage                   | 200/346 - 240/415V~         |
| Frequency                 | 50/60Hz                     |

| Product description    |   |
|------------------------|---|
| Protection degree      | IP44  |
| Colour code            | red RAL 3000  |
| Colour of appliance    | Hinged lid grey RAL 7035, Housing bottom grey RAL 7035, Enclosure grey RAL 7035 |
| Connection design      | with screw terminal   |
| Maximum conductor size | 10,0 qmm  |
| Cable entry            | other   |
| Height                 | 112.5mm   |
| Width                  | 90mm  |
| Depth                  | 93mm  |
| Dimension of enclosure | 90x90 mm  |
| Material of enclosure  | Polyamide   |
| Contacts               | the contact carrier is made of polyamide, the contacts are brass nickel plated  |

| Additional technical information |   |
|----------------------------------|---|
|                                  | The cable entry is one at top open and one at bottom closed |
|                                  | straight  |

| Logistics data |                |
|----------------|----------------|
| Weight/pcs     | 0.4 kg / Piece |
| Packaging      | Bag            |
| Content amount | 1 ST           |

| Logistics data |               |
|----------------|---------------|
| EAN            | 4024941945684 |
| Length         | 93 mm         |
| Width          | 90 mm         |
| Height         | 112.5 mm      |
| Weight         | 0.401 kg      |
| Volume         | 941.625 ccm   |
| Packaging      | Carton        |
| Content amount | 5 ST          |
| EAN            | 4024941945691 |
| Length         | 295 mm        |
| Width          | 185 mm        |
| Height         | 215 mm        |
| Weight         | 2.164 kg      |
| Volume         | 9,975 ccm     |

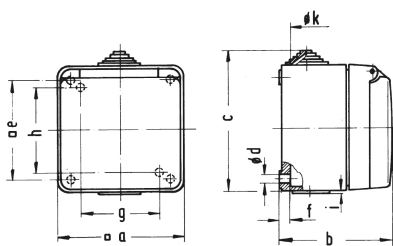

| Ampere Polzahl | 16<br>3   | 16<br>5   | 32<br>5   |  |  |  |  |
|----------------|-----------|-----------|-----------|--|--|--|--|
| a □            | 91,0      | 91,0      | 90,0      |  |  |  |  |
| b              | 79,5      | 79,5      | 93,0      |  |  |  |  |
| c              | 100,0     | 100,0     | 112,5     |  |  |  |  |
| d ø            | 5,5       | 5,5       | 5,5       |  |  |  |  |
| e □            | 73,0      | 73,0      | -         |  |  |  |  |
| f              | 7,0       | 7,0       | 6,0       |  |  |  |  |
| g              | -         | -         | 58,0      |  |  |  |  |
| h ø            | -         | -         | 73,0      |  |  |  |  |
| i              | -         | -         | 1,5       |  |  |  |  |
| k ø            | 20,0 max. | 20,0 max. | 8,0/ 20,0 |  |  |  |  |
|                |           |           |           |  |  |  |  |
|                |           |           |           |  |  |  |  |

4 MB 16