

## Wall mounting socket outlet - housing dimensions 91x91



| Product description       |                             |
|---------------------------|-----------------------------|
| BALS-Prd.-Nr              | 1183                        |
| EAN                       | 4024941011839               |
| Product category          | Wall mounting socket outlet |
| Current                   | 16A                         |
| Number of poles           | 3p                          |
| Arrangement of phases     | 2P+PE                       |
| Position of earth contact | 6 h                         |
| Voltage                   | 200 - 250V~                 |
| Frequency                 | 50/60Hz                     |

| Product description    |   |
|------------------------|---|
| Protection degree      | IP44  |
| Colour code            | blue RAL 5015   |
| Colour of appliance    | Hinged lid grey RAL 7035, Housing bottom grey RAL 7035, Enclosure grey RAL 7035 |
| Connection design      | with screw terminal   |
| Maximum conductor size | 4,0 qmm   |
| Cable entry            | Anti-kink sleeve  |
| Height                 | 100mm   |
| Width                  | 91mm  |
| Depth                  | 79.5mm  |
| Dimension of enclosure | 91x91 mm  |
| Material of enclosure  | Polyamide   |
| Contacts               | the contact carrier is made of polyamide, the contacts are brass                |

| Additional technical information |   |
|----------------------------------|---|
|                                  | The cable entry is one at top open and one at bottom and one rear side closed |
|                                  | straight  |

| Logistics data |                  |
|----------------|------------------|
| Weight/pcs     | 0.235 kg / Piece |
| Packaging      | Bag              |
| Content amount | 1 ST             |

| Logistics data |               |
|----------------|---------------|
| EAN            | 4024941011839 |
| Length         | 79.5 mm       |
| Width          | 91 mm         |
| Height         | 100 mm        |
| Weight         | 0.236 kg      |
| Volume         | 723.45 ccm    |
| Packaging      | Carton        |
| Content amount | 10 ST         |
| EAN            | 4024941968904 |
| Length         | 258 mm        |
| Width          | 183 mm        |
| Height         | 212 mm        |
| Weight         | 2.502 kg      |
| Volume         | 8,750 ccm     |

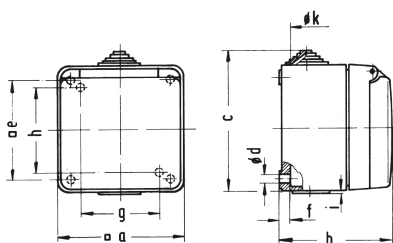

| Ampere Polzahl | 16<br>3   | 16<br>5   | 32<br>5   |  |  |  |  |
|----------------|-----------|-----------|-----------|--|--|--|--|
| a □            | 91,0      | 91,0      | 90,0      |  |  |  |  |
| b              | 79,5      | 79,5      | 93,0      |  |  |  |  |
| c              | 100,0     | 100,0     | 112,5     |  |  |  |  |
| d ø            | 5,5       | 5,5       | 5,5       |  |  |  |  |
| e □            | 73,0      | 73,0      | -         |  |  |  |  |
| f              | 7,0       | 7,0       | 6,0       |  |  |  |  |
| g              | -         | -         | 58,0      |  |  |  |  |
| h ø            | -         | -         | 73,0      |  |  |  |  |
| i              | -         | -         | 1,5       |  |  |  |  |
| k ø            | 20,0 max. | 20,0 max. | 8,0/ 20,0 |  |  |  |  |
|                |           |           |           |  |  |  |  |
|                |           |           |           |  |  |  |  |

4 MB 16