

Wall mounting socket outlet - housing dimensions 91x91



Product description	
BALS-Prd.-Nr	1186
EAN	4024941011860
Product category	Wall mounting socket outlet
Current	16A
Number of poles	5p
Arrangement of phases	3p+N+PE
Position of earth contact	6 h
Voltage	200/346 - 240/415V~
Frequency	50/60Hz

Product description	
Protection degree	IP44
Colour code	red RAL 3000
Colour of appliance	Hinged lid grey RAL 7035, Housing bottom grey RAL 7035, Enclosure grey RAL 7035
Connection design	with screw terminal
Maximum conductor size	4,0 qmm
Cable entry	Anti-kink sleeve
Height	100mm
Width	91mm
Depth	79.5mm
Dimension of enclosure	91x91 mm
Material of enclosure	Polyamide
Contacts	the contact carrier is made of polyamide, the contacts are brass

Additional technical information	
	The cable entry is one at top open and one at bottom and one rear side closed
	straight

Logistics data	
Weight/pcs	0.268 kg / Piece
Packaging	Bag
Content amount	1 ST

Logistics data	
EAN	4024941011860
Length	79.5 mm
Width	91 mm
Height	100 mm
Weight	0.269 kg
Volume	723.45 ccm
Packaging	Carton
Content amount	10 ST
EAN	4024941968379
Length	258 mm
Width	183 mm
Height	212 mm
Weight	2.832 kg
Volume	8,750 ccm

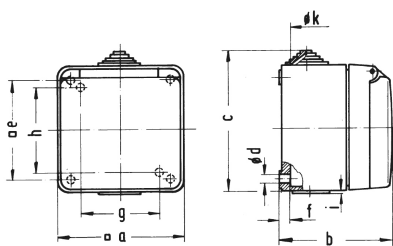

Ampere Polzahl	16 3	16 5	32 5				
a □	91,0	91,0	90,0				
b	79,5	79,5	93,0				
c	100,0	100,0	112,5				
d ø	5,5	5,5	5,5				
e □	73,0	73,0	-				
f	7,0	7,0	6,0				
g	-	-	58,0				
h ø	-	-	73,0				
i	-	-	1,5				
k ø	20,0 max.	20,0 max.	8,0/ 20,0				

4 MB 16