

panel mounting socket outlet, angled - flange 75x75,  
fixing centers 60x60



Product description	
BALS-Prd.-Nr	1220011
EAN	4024941379458
Product category	Panel mounting socket outlet INNOLINQ QUICK-CONNECT angled
Current	16A
Number of poles	5p
Arrangement of phases	3p+N+PE
Position of earth contact	6 h
Voltage	200/346 - 240/415V~

Product description	
Frequency	50/60Hz
Protection degree	IP54
Colour code	red RAL 3000
Colour of appliance	Hinged lid red RAL 3000, Enclosure grey RAL 7035
Connection design	screwless spring terminals with KONTEX-ULTRA contact
Maximum conductor size	4,0 qmm
Cable entry	other
Height	95mm
Width	75mm
Depth	97mm
Flange size vertical in mm	75mm
Flange size horizontal in mm	75mm
Drill hole dist. vertical mm	60mm
Drill hole dist. horizontal mm	60mm
Material of enclosure	Polyamide
Contacts	The contacts are brass, The contact carrier is made of high temperature resistant material

Additional technical information	
	The inclination is 20°, This product is without any lead

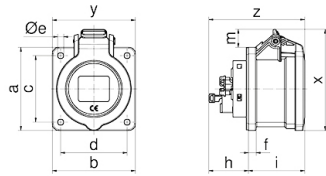

Einbauöffnung



4MB502

Ampere	16	16	32
Poles	3	5	5
a	75,0	75,0	75,0
b	75,0	75,0	75,0
c	60,0	60,0	60,0
d	60,0	60,0	60,0
Øe	5,5	5,5	5,5
f	7,0	7,0	7,0
h	36,0	36,0	46,0
i	50,0	51,0	62,0
Øl	45,0	55,0	60,0
m	8,0	16,5	23,5
x	83,0	92,0	105,0
y	75,0	75,0	75,5
z	86,0	87,0	108,0

