

panel mounting socket outlet, angled - flange 100x92,
fixing centers 85x77



Product description	
BALS-Prd.-Nr	1270
EAN	4024941012706
Product category	Panel mounting socket outlet, angled
Current	16A
Number of poles	4p
Arrangement of phases	3P+PE
Position of earth contact	6 h
Voltage	380 - 415V~

Product description	
Frequency	50/60Hz
Protection degree	IP67
Colour code	red RAL 3000
Colour of appliance	Hinged lid red RAL 3000, Bayonet ring grey RAL 7035, Enclosure grey RAL 7035
Connection design	with screw terminal
Maximum conductor size	4,0 qmm
Cable entry	other
Height	100mm
Width	92mm
Depth	83mm
Flange size vertical in mm	100mm
Flange size horizontal in mm	92mm
Drill hole dist. vertical mm	85mm
Drill hole dist. horizontal mm	77mm
Material of enclosure	Polyamide
Contacts	The contact carrier is made of polyamide, The contacts are brass

Additional technical information	
	The inclination is 20°

Logistics data	
Weight/pcs	0.182 kg / Piece
Packaging	Bag
Content amount	1 ST
EAN	4024941012706
Length	83 mm
Width	92 mm
Height	100 mm
Weight	0.183 kg
Volume	763.6 ccm
Packaging	Carton
Content amount	10 ST
EAN	4024941967631
Length	245 mm
Width	177 mm
Height	185 mm
Weight	1.953 kg
Volume	7,140 ccm

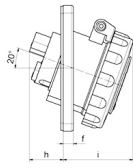
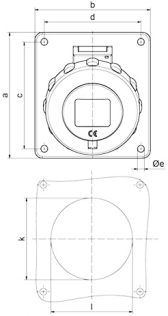

4MB184

Ampere	16	16	32	32	32		
Polzahl	4	5	3	4	5		
a	100,0	100,0	100,0	100,0	100,0		
b	92,0	92,0	92,0	92,0	92,0		
c	85,0	85,0	85,0	85,0	85,0		
d	77,0	77,0	77,0	77,0	77,0		
Ø e	5,5	5,5	5,5	5,5	5,5		
f	8,0	8,0	8,0	8,0	8,0		
h	28,5	29,0	50,0	50,0	34,0		
i	57,5	60,0	67,0	67,0	69,0		
k	65,0	70,0	75,0	75,0	78,0		
l	65,0	70,0	75,0	75,0	78,0		