

Panel mounting socket outlet - TN - flange 75x75 fixing centers 60x60



Product description	
BALS-Prd.-Nr	13066
EAN	4024941130660
Product category	TN panel mounting socket outlet QUICK-CONNECT, straight
Current	32A
Number of poles	5p
Arrangement of phases	3p+N+PE
Position of earth contact	6 h
Voltage	200/346 - 240/415V~

Product description	
Frequency	50/60Hz
VG-type-no.:	VG 96919 AS 005
Supply no.:	5935-12-300-5323
Protection degree	IP67
Colour code	bronze-green RAL 6031-F9
Colour of appliance	Bayonet ring bronze-green RAL 6031-F9, Hinged lid bronze-green RAL 6031-F9, Enclosure bronze-green RAL 6031-F9
Connection design	screwless spring terminals with KONTEX-contact
Maximum conductor size	10,0 qmm
Cable entry	other
Height	106mm
Width	101.5mm
Depth	113mm
Flange size vertical in mm	75mm
Flange size horizontal in mm	75mm
Drill hole dist. vertical mm	60mm
Drill hole dist. horizontal mm	60mm
Material of enclosure	Polyamide
Contacts	the contact carrier is made of high temperature resistant material, the contacts are brass nickel plated

Additional technical information

With bayonet cover on strap

Logistics data

Weight/pcs	0.298 kg / Piece
------------	------------------

Packaging	Bag
-----------	-----

Content amount	1 ST
----------------	------

EAN	4024941130660
-----	---------------

Length	113 mm
--------	--------

Width	101.5 mm
-------	----------

Height	106 mm
--------	--------

Weight	0.299 kg
--------	----------

Volume	1,215.767 ccm
--------	---------------

Packaging	Carton
-----------	--------

Content amount	10 ST
----------------	-------

EAN	4024941821216
-----	---------------

Length	122 mm
--------	--------

Width	222 mm
-------	--------

Height	538 mm
--------	--------

Weight	3.318 kg
--------	----------

Volume	14,332.32 ccm
--------	---------------

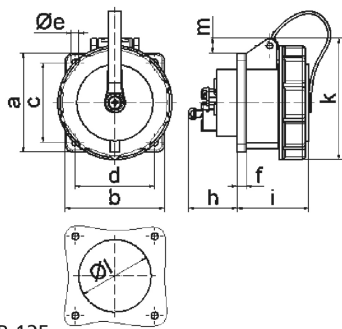

Ampere Polzahl	16 3	16 4	16 5	32 3	32 4	32 5
a	75,0	75,0	75,0	75,0	75,0	75,0
b	75,0	75,0	75,0	75,0	75,0	75,0
c	60,0	60,0	60,0	60,0	60,0	60,0
d	60,0	60,0	60,0	60,0	60,0	60,0
e ø	5,5	5,5	5,5	5,5	5,5	5,5
f	7,0	7,0	7,0	8,0	8,0	8,0
h	35,0	35,0	35,0	50,0	50,0	50,0
i	57,0	57,0	57,0	69,0	69,0	69,0
k	77,0	83,0	93,0	98,0	98,0	107,0
l ø	45,0	75,0	55,0	60,0	60,0	60,0
m	4,0	7,0	12,0	12,0	12,0	17,0
Leiter mm² min	1,5	1,5	1,5	2,5	2,5	2,5
Leiter mm² max	4,0	4,0	4,0	10,0	10,0	10,0