

Wall mounting appliance inlet - with external fixing



| Product description | |
|---------------------------|---------------------------------------------|
| BALS-Prd.-Nr | 24405 |
| EAN | 4024941244053 |
| Product category | wall mounting appliance inlet QUICK-CONNECT |
| Current | 32A |
| Number of poles | 4p |
| Arrangement of phases | 3P+PE |
| Position of earth contact | 6 h |
| Voltage | 380 - 415V~ |
| Frequency | 50/60Hz |

| Product description | |
|------------------------|-----------------------------------------------------------------------------|
| Protection degree | IP44 |
| Colour code | red RAL 3000 |
| Colour of appliance | Housing top red RAL 3000, Collar red RAL 3000, Housing bottom grey RAL 7035 |
| Connection design | screwless spring-clamp technology |
| Maximum conductor size | 6,0 qmm |
| Cable entry | top entry M25 |
| Height | 133mm |
| Width | 94mm |
| Depth | 87mm |
| Dimension of enclosure | 92x94 mm (HxW) |
| Material of enclosure | Polyamide |
| Contacts | the contact carrier is made of polyamide, the contacts are brass |

| Additional technical information | |
|----------------------------------|-------------------------------------------------------------|
| | The cable entry is one at top open and one at bottom closed |

| Logistics data | |
|----------------|------------------|
| Weight/pcs | 0.249 kg / Piece |
| Packaging | Bag |
| Content amount | 1 ST |
| EAN | 4024941244053 |

| Logistics data | |
|----------------|---------------|
| Length | 87 mm |
| Width | 94 mm |
| Height | 133 mm |
| Weight | 0.25 kg |
| Volume | 1,087.674 ccm |
| Packaging | Carton |
| Content amount | 10 ST |
| EAN | 4024941958158 |
| Length | 325 mm |
| Width | 217 mm |
| Height | 210 mm |
| Weight | 2.696 kg |
| Volume | 13,588.4 ccm |

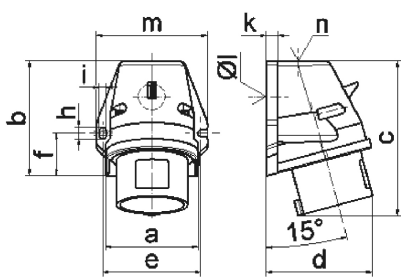

5 MB 44

| Ampere | 16 | 16 | 16 | 32 | 32 | 32 |
|----------------|-------|-------|-------|-------|-------|-------|
| Polzahl | 3 | 4 | 5 | 3 | 4 | 5 |
| a | 59,5 | 72,4 | 72,4 | 79,1 | 79,1 | 79,1 |
| b | 90,0 | 90,0 | 90,0 | 92,0 | 92,0 | 92,0 |
| c | 120,0 | 120,0 | 122,0 | 134,0 | 134,0 | 134,0 |
| d | 72,0 | 84,0 | 84,0 | 89,0 | 89,0 | 89,0 |
| e | 62,0 | 77,0 | 77,0 | 84,0 | 84,0 | 84,0 |
| f | 33,5 | 33,5 | 33,5 | 30,0 | 30,0 | 30,0 |
| h | 9,0 | 9,0 | 9,0 | 9,0 | 9,0 | 9,0 |
| i | 5,5 | 5,5 | 5,5 | 5,5 | 5,5 | 5,5 |
| k | 8,0 | 9,0 | 9,0 | 9,0 | 9,0 | 9,0 |
| l Ø | 21,0 | 21,0 | 21,0 | 21,0 | 21,0 | 21,0 |
| m | 72,0 | 87,0 | 87,0 | 94,0 | 94,0 | 94,0 |
| n | M20 | M25 | M25 | M25 | M25 | M25 |
| Leiter mm² min | 1 | 1 | 1 | 2,5 | 2,5 | 2,5 |
| Leiter mm² max | 2,5 | 2,5 | 2,5 | 6 | 6 | 6 |